

# HIGH-MOUNT BRAKE LIGHT REMOVAL/INSTALLATION

B3E091851580W01

## 4SD

1. Disconnect the negative battery cable.
2. Remove the trunk lid trim. (See [TRUNK LID TRIM REMOVAL/INSTALLATION](#).)
3. Remove in the order indicated in the table.

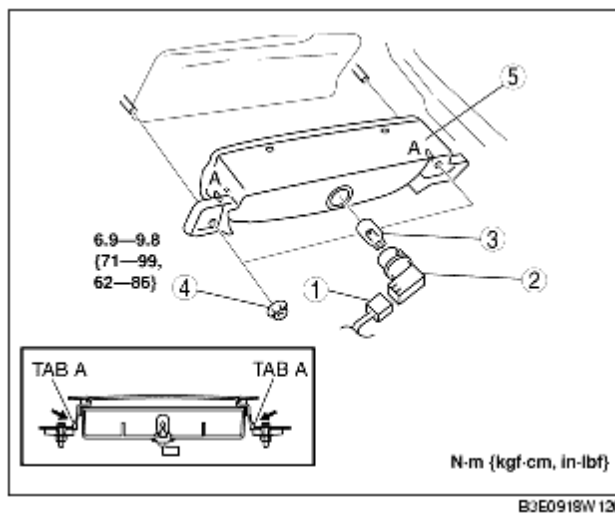

1	Connector
2	Socket
3	High-mount brake light bulb
4	Nut
5	High-mount brake light

4. Install in the reverse order of removal.

## 5HB

1. Disconnect the negative battery cable.
2. Remove the liftgate upper trim. (See [LIFTGATE UPPER TRIM REMOVAL/INSTALLATION](#).)
3. Remove in the order indicated in the table.

1	Connector
2	Socket
3	High-mount brake light bulb
4	High-mount brake light

4. Install in the reverse order of removal.